



Installing a Free Play button in your Hockey Table

The Air Hockey table does not have a Free Play option, in order to convert it over you will need to install a button on the outside connected to the coin switch.

- **Tools needed**

Drill
Hole Saw 1 1/8"



Parts Needed.

Valley-Dynamo part number [860800475](#)

(Available at www.valleydynamoparts.com – many Vending Suppliers sell a functionally identical button)

1. On the Lower Bill Acceptor plate on your Coin door, use the Hole saw to drill a 1 1/8" hole. (See Drawing on page 2). We recommend locating the button here because the plate can be replaced easily if there are issues cutting the hole, or if you wish to change the table back to coin-operation in the future
2. Install the button in the hole drilled by following the instructions that came with the button.
3. Move the Brown wire from the coin switch to the N.O. connection on the button installed. (See the Wiring diagram on page 3 to identify the wiring and page 2 to identify the coin switch.)
4. Move the Blue wire from the coin switch to the COM connection on the button installed. (See the Wiring diagram on page 3 to identify the wiring and page 2 to identify the coin switch.)
5. It may be necessary to adjust the program. On newer tables, the inside of the service door will provide instructions on how to access the programming and step through the available levels. The Value button adjusts the setting.



You will need to adjust the parameter CC (coins per Credit) to 1 whether your table uses the v7.0, v7.2 or v9.0 PCB.

Note; Every time the button is pushed it will give you a game, there is a 10 second delay after the button is pushed before the blower motor starts.

On older table using a push chute coin mechanism, the easiest way to change your table to free play is simply to configure the coin mech with blanks so no coins are required. This is also extremely easy to reverse should you wish to change the table back to coin operation.

If you have any questions or confusion about this process, please contact us at techhelp@valley-dynamo.com before proceeding and accidentally causing damage to your table that could be difficult or expensive to repair (or both!!)

ITEM NO.	QTY.	PART NO.	DESCRIPTION
1	2	42-0231-100	ENTRY BEZEL
2	2	42-0038-100	REJECT BUTTON ASY. YELLOW \$1.00 4X.25 1 PLAY W/L SHAFT
3	2	43-1002-00	WASHER, FLAT #6
4	2	42-8156-00	MECH HOLDER W/2 METAL CLIPS & 14V LMP SW .25 HAPP MECH
5	2	42-0232-100	RETURN BEZEL
6	2	42-0119-00	RETURN DOOR FLAP
7	1	42-0063-00	KEY HOOK
8	1	42-0065-00	SCREW 8 X 1/4
9	1	42-0641-00	LOCK ASSY 7/8 W/1 1/8" STRAIGHT CAM
10	1	95-0278-00	DANGER LABEL
11	8	48-1000-00	SCREW FOR BEZEL
12	4	43-1003-00	SCREW, PLASTIC #4 X .42
13	1	890-1060-00	LABEL UPSTACKER INSTRUCTIONS
14	1	42-0254-02	LOCKWASHER, F/LOCK 3/4" INT.
15	1	42-3676-100	COIN DOOR PINBALL 2 ENTRY WITH VALIDATOR PLATES INSTALLED
16	1	891-1701-016	FRAME STD DRH S2000 NOTCH BLK
17	4	890-1002-00	SCREW F/ HINGE M3X6MM .5 PITCH PH PAN HD ZINC
18	2	42-1035-00	INCLINED PLASTIC SEPERATOR IL 7 DEGREES
19	1	42-1039-00	BRACKET F/NRI WAKE-UP SENSOR
20	1	42-0314-00	SCREW 6-32 X 3/8 PH PAN HD
21	4	43-0066-00	WASHER, #4 FLAT
22	4	43-0203-00	NUT, HEX M3

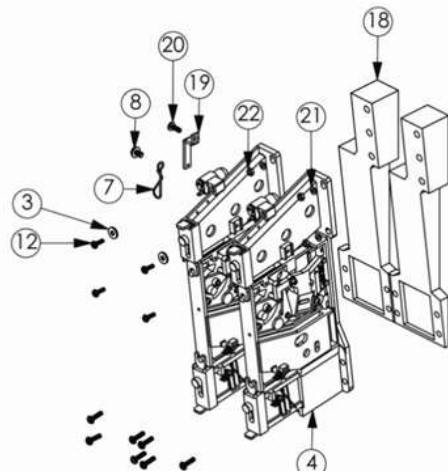
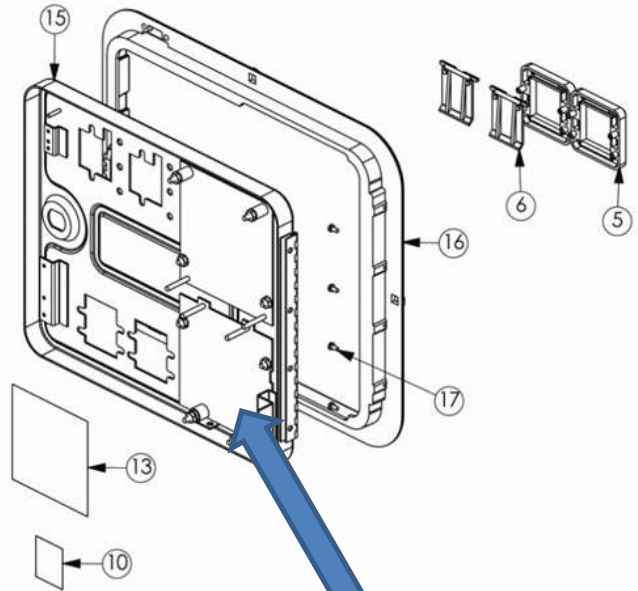
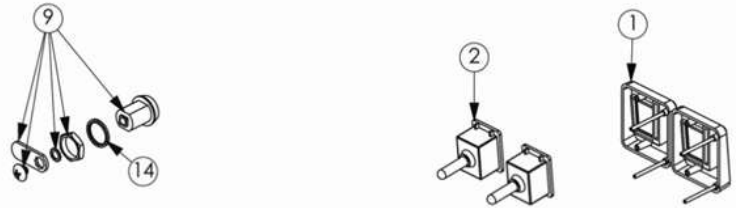

Lower Bill Acceptor Plate

Coin Switch Wiring

